

- ### NOTES
1. Do not scale from drawing.
 2. Drawing to be printed in color.
 3. All sign and road marking diagram in accordance with TSRGD 2016.
 4. All traffic signs and road marking are indicative only and to be confirmed at detailed design.

KEY

 New footway construction.

New 800mm deep corduroy paving in colour buff to be installed where a footway crosses the cycle route. This informs visually impaired pedestrians in accordance with Guidance on use of Tactile Paving Surfaces.

Proposed 20mph zone.

// Sheffield cycle stand or similar approved location.

Proposed traffic sign location.

New Kerb Alignment.

 Existing kerb to be removed.

— Proposed road markings.

— Existing road markings.

 Proposed National Cycle Route sign on new post.

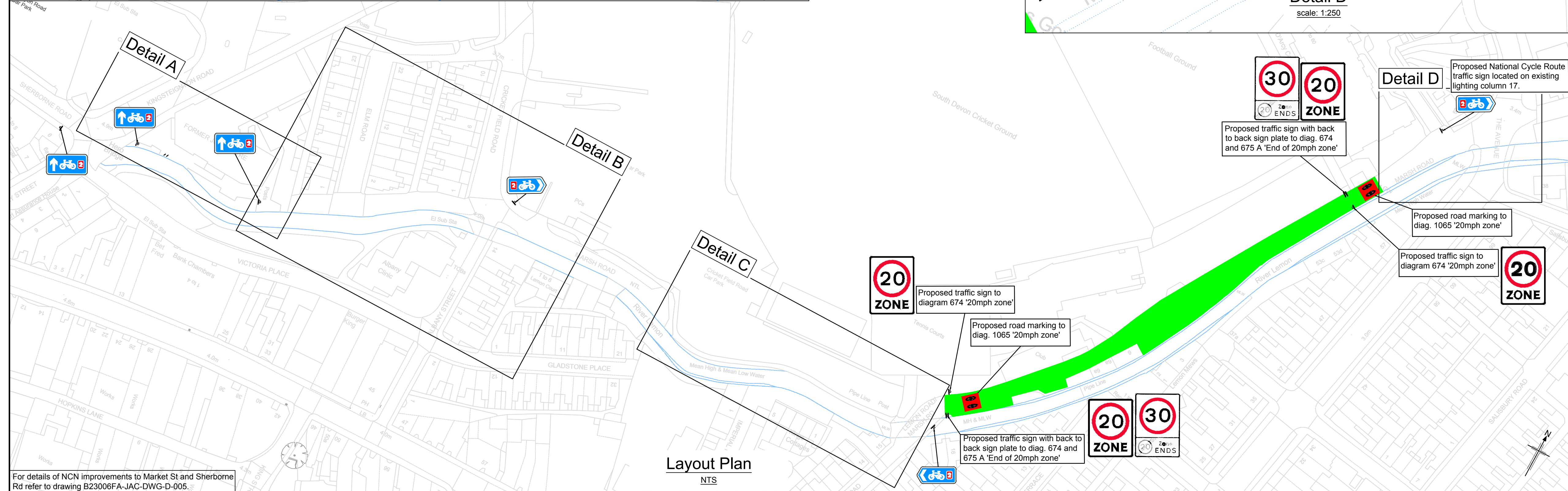

P04	Jul. 2020	MINOR AMENDMENTS	DdG	EH	EH	SB	
P03	Feb. 2020	MINOR AMENDMENTS	DdG	GS	ON	SB	
P02	Jan. 2020	MINOR AMENDMENTS	DdG	GS	ON	SB	
P01	Jan. 2020	FOR INFORMATION	DdG	GS	ON	SB	
Rev	Rev. Date	Purpose of revision	Drawn	Checked	Rev'd	Apprv	

Client	
--------	--



JACOBS'

Aperture, Pynes Hill, Rydon Lane, Exeter EX2 5AZ
Tel: +44(0)1392 269 800
Website : www.jacobs.com

Project	
---------	--

B23006FA - Newton Abbot Future
High Street Fund

Drawing title

Drawing title

National Cycle Route
Victoria Gardens to The Avenue
General Arrangement

	Drawing status
--	----------------

FOR INFORMATION

Scale	AS SHOWN @ A1	DO NOT SCALE
-------	---------------	--------------

Jacobs No.	B23006FA
------------	----------

Drawing number	Rev
----------------	-----

B23006FA-JAC-DWG-C-004	P04
------------------------	-----

© Copyright 2019, Jacobs U.K. Limited. The concepts and information contained in this document are the property of Jacobs. Use or copying of this document in whole or in part without the written permission of Jacobs constitutes an infringement of

Use or copying of this document in whole or in part without the written permission of Jacobs constitutes an infringement of copyright. Limitation: This drawing has been prepared on behalf of, and for the exclusive use of Jacobs' Client, and is subject to, and issued in accordance with the provisions of the contract between Jacobs and the Client. Jacobs accepts no liability or

responsibility whatsoever for, or in respect of, any use of, or reliance upon, this drawing by any third party.